

## Druckarmaturen DKR 90°

### Anschluss

Dichtkopf 60° Außenkonus mit BSPP Mutter (G)

### Norm

ISO 8434-6

### Anwendung

TE / SN / SC / SN-K / PTFE Schläuche

### Werkstoff

Stahl

### Oberfläche

galvanisch verzinkt

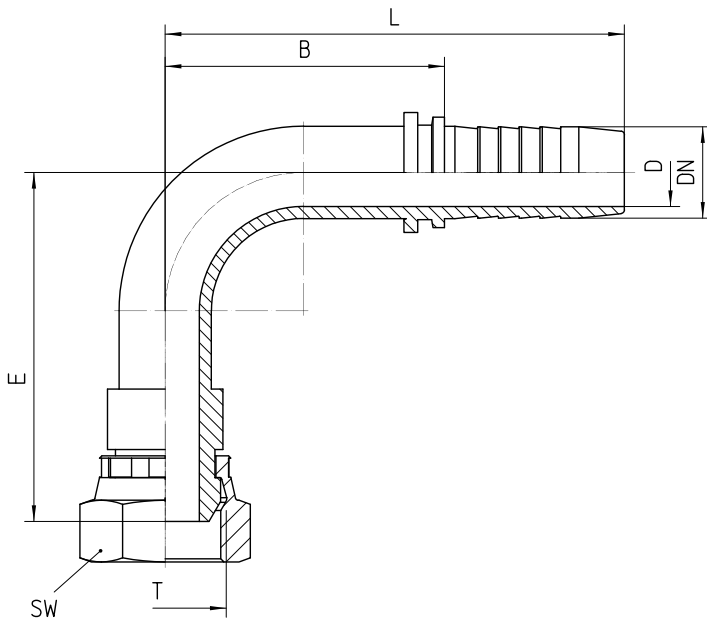



Bestell-Nr.	DN in mm	T in Zoll	SW in mm	min. D in mm	E±3 in mm	B±3 in mm	L±3 in mm
<b>1.243-04-04</b>	06	G 1/4	19	4,0	27	25	53
<b>1.243-06-04</b>	06	G 3/8	22	4,0	31	25	53
<b>1.243-04-05</b>	08	G 1/4	17	5,5	30	30	57
<b>1.243-06-05</b>	08	G 3/8	22	5,5	36	29	57
<b>1.243-06-06</b>	10	G 3/8	22	7,0	30	32	62
<b>1.243-08-06</b>	10	G 1/2	27	7,0	40	31	61
<b>1.243-06-08</b>	12	G 3/8	22	7,0	46	42	73
<b>1.243-08-08</b>	12	G 1/2	27	10,0	52	42	73
<b>1.243-10-08</b>	12	G 5/8	30	10,0	52	42	73
<b>1.243-08-10</b>	16	G 1/2	27	10,0	53	52	86
<b>1.243-10-10</b>	16	G 5/8	30	12,0	60	52	86
<b>1.243-12-10</b>	16	G 3/4	32	12,6	62	52	86
<b>1.243-10-12</b>	19	G 5/8	30	12,0	61	60	99
<b>1.243-12-12</b>	19	G 3/4	32	14,8	75	60	99
<b>1.243-16-12</b>	19	G 1	41	14,8	76	62	101

<b>1.243-12-16</b>	25	G 3/4	32	14,8	72	64	111
<b>1.243-16-16</b>	25	G 1	41	20,0	87	69	116
<b>1.243-20-16</b>	25	G 1 1/4	50	20,0	83	67	114
<b>1.243-16-20</b>	31	G 1	41	21,0	84	93	148
<b>1.243-20-20</b>	31	G 1 1/4	50	26,5	92	93	148
<b>1.243-24-20</b>	31	G 1 1/2	55	26,5	91	93	148
<b>1.243-20-24</b>	38	G 1 1/4	50	26,5	97	104	162
<b>1.243-24-24</b>	38	G 1 1/2	55	32,5	101	104	162
<b>1.243-32-24</b>	38	G 2	70	32,5	102	104	162
<b>1.243-24-32</b>	51	G 1 1/2	55	32,5	120	130	205
<b>1.243-32-32</b>	51	G 2	70	44,5	121	130	205
<b>1.243-40-36</b>	60	G 2 1/2	85	52,0	129	173	253
<b>1.243-40-40</b>	63	G 2 1/2	85	52,0	130	170	250
<b>1.243-48-48</b>	76	G 3	100	68,0	145	150	225