

Saug- & Niederdruckarmaturen DKOL 45°

Anschluss

Dichtkopf 24° Außenkonus O-Ring-dichtend mit metrischer Mutter L-Reihe

Norm

ISO 8434-1

Anwendung

14A / 17A Schläuche

Werkstoff

Stahl

Oberfläche

galvanisch verzinkt

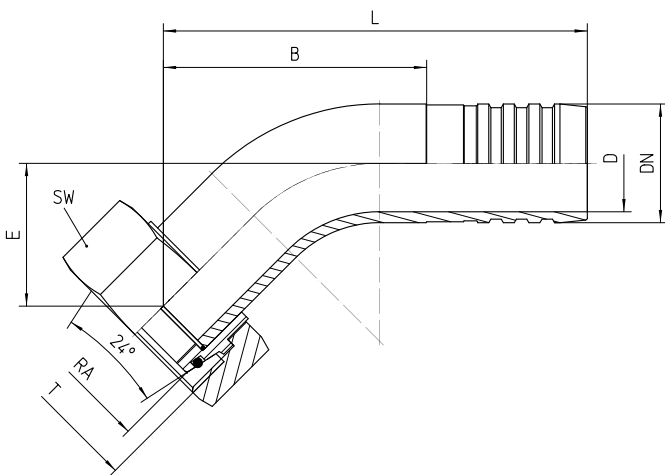
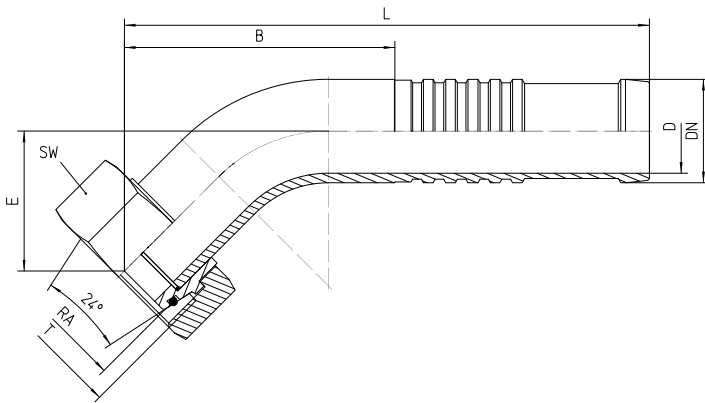

Bestell-Nr.	DN in	RA	T	SW in	D in	E±3	B±3	L±3 in	Bestell-	B±3	L±3 in
-------------	-------	----	---	-------	------	-----	-----	--------	----------	-----	--------

	mm			mm	mm	in mm	in mm	mm	Nr.Kurz	in mm	mm
17.055-10-12	19	18L	M 26x1.5	32	14	27	60	140	17.055K- 10-12	56	100
17.055-12-12	19	22L	M 30x2.0	36	14	27	60	140	17.055K- 12-12	56	100
17.055-16-12	19	28L	M 36x2.0	41	14	27	60	140	17.055K- 16-12	56	100
17.055-12-16	25	22L	M 30x2.0	36	19	34	70	150	17.055K- 12-16	61	105
17.055-16-16	25	28L	M 36x2.0	41	19	34	70	150	17.055K- 16-16	61	105
17.055-20-16	25	35L	M 45x2.0	51	19	34	71	151	17.055K- 20-16	61	105
17.055-24-16	25	42L	M 52x2.0	60	19	34	71	151	17.055K- 24-16	61	105
17.055-12-20	31	22L	M 30x2.0	36	26	46	80	160	17.055K- 12-20	76	120
17.055-16-20	31	28L	M 36x2.0	41	26	46	89	169	17.055K- 16-20	76	120
17.055-20-20	31	35L	M 45x2.0	50	26	45	86	166	17.055K- 20-20	78	122
17.055-24-20	31	42L	M 52x2.0	60	26	45	82	162	17.055K- 24-20	78	122
17.055-12-24	38	22L	M 30x2.0	36	32	70	115	195	17.055K- 12-24	111	155
17.055-16-24	38	28L	M 36x2.0	41	32	53	115	195	17.055K- 16-24	88	132
17.055-20-24	38	35L	M 45x2.0	50	32	53	115	195	17.055K- 20-24	106	150
17.055-24-24	38	42L	M 52x2.0	60	32	53	115	195	17.055K- 24-24	96	140
17.055-16-32	51	28L	M 36x2.0	41	44	57	131	223	17.055K- 16-32	124	169

17.055-20-32	51	35L	M 45x2.0	50	44	57	131	223	17.055K- 20-32	124	169
17.055-24-32	51	42L	M 52x2.0	60	44	57	131	223	17.055K- 24-32	124	169
17.055-20-36	60	35L	M 45x2.0	50	53	57	101	193	17.055K- 20-36	120	165
17.055-24-36	60	42L	M 52x2.0	60	53	61	113	205	17.055K- 24-36	120	165