

Suction and low-pressure fittings DKM 90°

Connection

Sealing head 60° outside cone with metric nut LL series

Standard

DIN 3863

Application

14A / 17A flexible tubes

Material

Steel

Surface protection

Zinc-electroplated

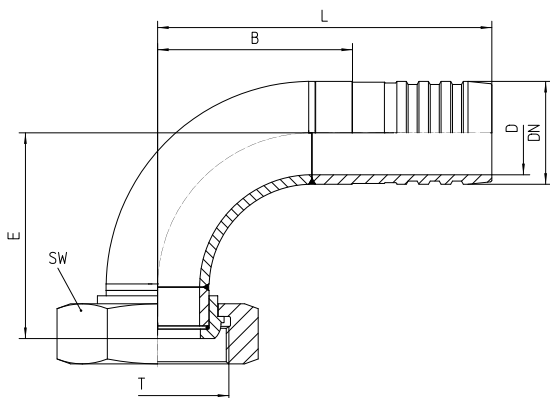
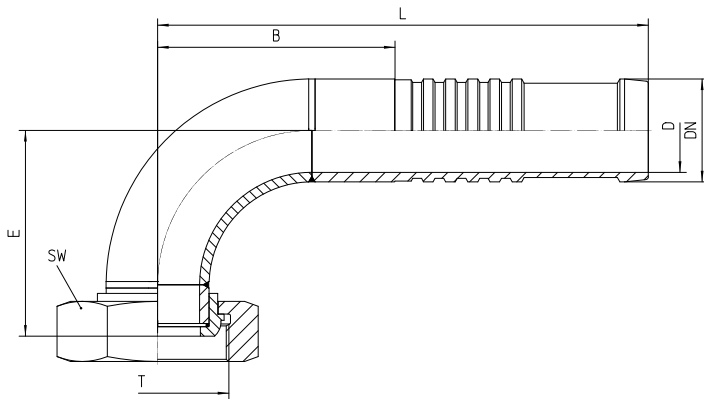

Bestell-Nr.	DN in mm	T	SW in mm	D in mm	E±3 in mm	B±3 in mm	L±3 in mm	Order No.	B±3 in mm	L±3 in mm

17.019-12-12	19	M30x1.5	36	14	54	50	127	17.019K-12-12	50	94
17.019-16-12	19	M38x1.5	46	14	54	50	127	17.019K-16-12	50	94
17.019-12-16	25	M30x1.5	36	19	60	56	139	17.019K-12-16	56	100
17.019-16-16	25	M38x1.5	46	19	54	56	139	17.019K-16-16	56	100
17.019-20-16	25	M45x1.5	55	19	54	56	139	17.019K-20-16	56	100
17.019-12-20	31	M30x1.5	36	26	89	62	155	17.019K-12-20	62	106
17.019-16-20	31	M38x1.5	46	26	69	62	155	17.019K-16-20	62	106
17.019-20-20	31	M45x1.5	55	26	64	62	155	17.019K-20-20	62	106
17.019-24-20	31	M52x1.5	60	26	63	62	155	17.019K-24-20	62	106
17.019-16-24	38	M38x1.5	46	32	94	71	170	17.019K-16-24	71	115
17.019-20-24	38	M45x1.5	55	32	84	71	170	17.019K-20-24	71	115
17.019-24-24	38	M52x1.5	60	32	74	71	170	17.019K-24-24	71	115
17.019-32-24	38	M65x2.0	75	32	74	71	170	17.019K-32-24	71	115
17.019-20-32	51	M45x1.5	55	44	129	128	220	17.019K-20-32	121	166
17.019-24-32	51	M52x1.5	60	44	127	128	220	17.019K-24-32	121	166
17.019-32-32	51	M65x2.0	75	44	105	128	220	17.019K-32-32	121	166
17.019-40-32	51	M78x2.0	90	44	107	128	220	17.019K-	121	166

								40-32		
17.019-24-36	60	M52x1.5	60	53	115	89	181	17.019K-24-36	96	141
17.019-32-36	60	M65x2.0	75	53	111	89	181	17.019K-32-36	96	141
17.019-40-36	60	M78x2.0	90	53	106	89	181	17.019K-40-36	96	141
17.019-48-36	60	M90x2.0	100	53	130	123	213	17.019K-48-36	96	141
17.019-32-48	76	M65x2.0	75	69	130	125	215	17.019K-32-48	130	175
17.019-40-48	76	M78x2.0	90	69	138	125	215	17.019K-40-48	130	175
17.019-48-48	76	M 90x2.0	100	69	131	125	215	17.019K-48-48	130	175
17.019-56-48	76	M100x2	110	69	132	125	215	17.019K-56-48	130	175
17.019-40-56	90	M78x2	90	82	133	154	223	17.019K-40-56	128	173
17.019-48-56	90	M90x2.0	100	82	168	144	234	17.019K-48-56	149	194
17.019-56-56	90	M100x2.0	110	82	162	144	234	17.019K-56-56	149	194
17.019-48-64	102	M90x2.0	100	94	159	160	252	17.019K-48-64	144	192
17.019-56-64	102	M100x2.0	110	94	182	163	253	17.019K-56-64	165	213