

# Suction and low-pressure fittings fixed DIN flange straight

**Connection**  
DIN flange fixed

**Standard**  
DIN 2633/2527 (new: EN1092-1, Typ 11 PN16 and Typ 05 PN16)

**Application**  
14A / 17A flexible tubes

**Material**  
Steel

**Surface protection**  
Zinc-electroplated

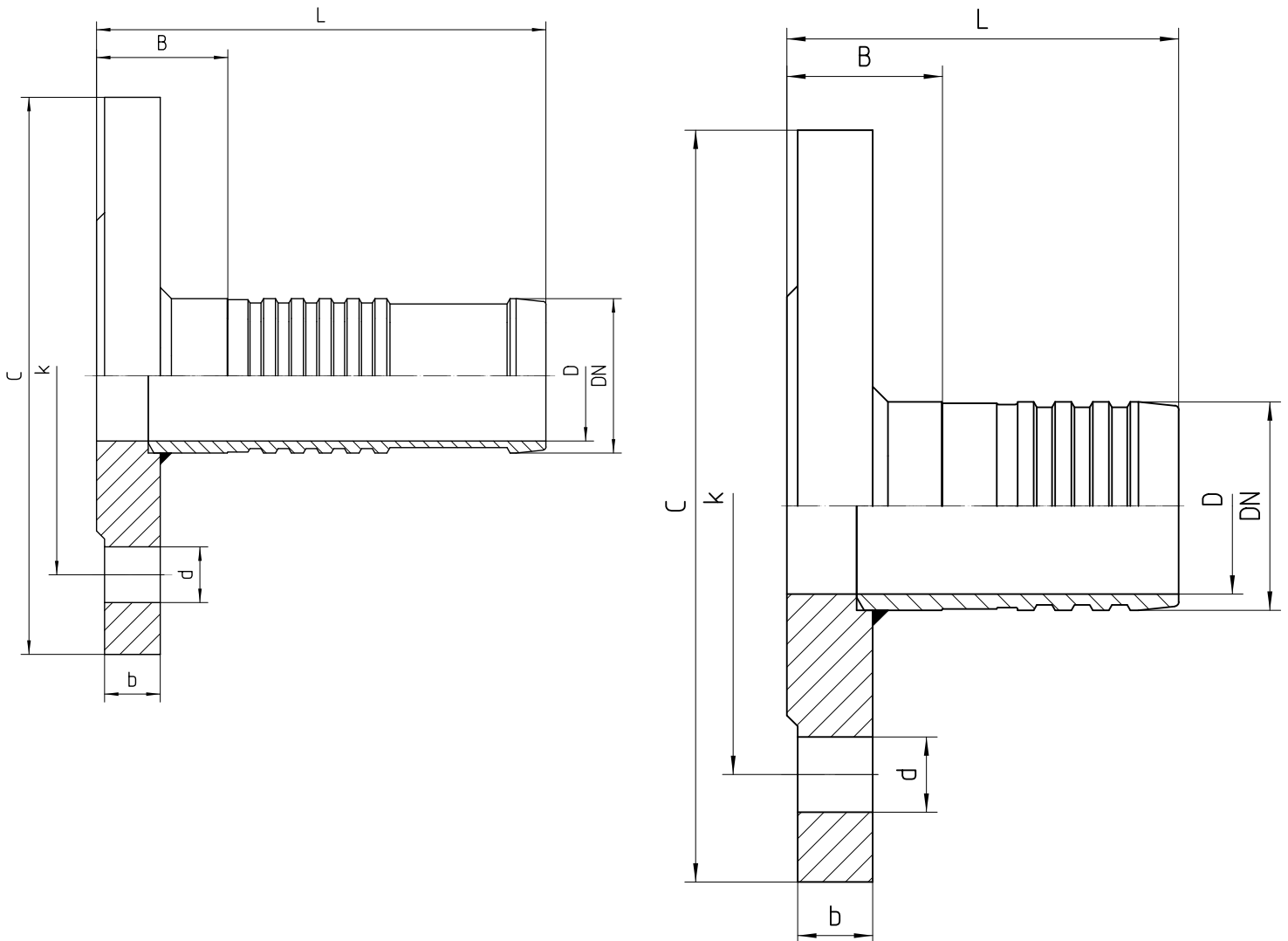

Bestell-Nr.	DN in mm	DN DIN-Flange	C in mm	b in mm	k in mm	number of screws	screws T	d in mm	D in mm	B±3 mm	L±3 mm	Order No.	B±3 mm	L±3 mm
17.424-12-12	19	20	105	16 (18)	75	4	M12	14	14	33 (35)	113 (115)	17.424K-12-12	29 (31)	73 (75)
17.424-16-12	19	25	115	16 (18)	85	4	M12	14	14	34 (36)	114 (116)	17.424K-16-12	30 (32)	74 (76)
17.424-12-16	25	20	105	16 (18)	75	4	M12	14	19	33 (35)	113 (115)	17.424K-12-16	29 (31)	73 (75)
17.424-16-16	25	25	115	16 (18)	85	4	M12	14	19	34 (36)	114 (116)	17.424K-16-16	30 (32)	74 (76)
17.424-20-16	25	32	140	16 (18)	100	4	M16	18	19	33 (35)	113 (115)	17.424K-20-16	29 (31)	73 (75)
17.424-12-20	31	20	105	16 (18)	75	4	M12	14	26	33 (35)	113 (115)	17.424K-12-20	29 (31)	73 (75)
17.424-16-20	31	25	115	16 (18)	85	4	M12	14	26	34 (36)	114 (116)	17.424K-16-20	30 (32)	74 (76)
17.424-20-20	31	32	140	16 (18)	100	4	M16	18	26	33 (35)	113 (115)	17.424K-20-20	29 (31)	73 (75)
17.424-24-20	31	40	150	16 (18)	110	4	M16	18	26	34 (36)	114 (116)	17.424K-24-20	30 (32)	74 (76)
17.424-12-24	38	20	105	16 (18)	75	4	M12	14	32	33 (35)	113 (115)	17.424K-12-24	29 (31)	73 (75)
17.424-16-24	38	25	115	16 (18)	85	4	M12	14	32	34 (36)	114 (116)	17.424K-16-24	30 (32)	74 (76)
17.424-20-24	38	32	140	16 (18)	100	4	M16	18	32	33 (35)	113 (115)	17.424K-20-24	34 (36)	73 (75)
17.424-24-24	38	40	150	16 (18)	110	4	M16	18	32	34 (36)	114 (116)	17.424K-24-24	30 (32)	74 (76)
17.424-32-24	38	50	165	18	125	4	M16	18	32	55	135	17.424K-32-24	31	75
17.424-16-32	51	25	115	16 (18)	85	4	M12	14	44	45 (47)	137 (139)	17.424K-16-32	52 (54)	97 (99)
17.424-20-32	51	32	140	16 (18)	100	4	M16	18	44	31 (33)	123 (125)	17.424K-20-32	38 (40)	83 (85)
17.424-24-32	51	40	150	16 (18)	110	4	M16	18	44	32 (34)	124 (126)	17.424K-24-32	39 (41)	84 (86)

<b>17.424-32-32</b>	51	50	165	18	125	4	M16	18	44	33	125	17.424K-32-32	35	80
<b>17.424-40-32</b>	51	65	185	18	145	4 (8)	M16	18	44	34	126	17.424K-40-32	41	86
<b>17.424-16-36</b>	60	25	115	16 (18)	85	4	M12	14	53	82 (84)	174 (176)	17.424K-16-36	89 (91)	134 (136)
<b>17.424-20-36</b>	60	32	140	16 (18)	100	4	M16	18	53	44 (46)	136 (138)	17.424K-20-36	51 (53)	96 (98)
<b>17.424-24-36</b>	60	40	150	16 (18)	110	4	M16	18	53	42 (44)	134 (136)	17.424K-24-36	49 (51)	94 (96)
<b>17.424-32-36</b>	60	50	165	18	125	4	M16	18	53	43	135	17.424K-32-36	50	95
<b>17.424-40-36</b>	60	65	185	18	145	4 (8)	M16	18	53	44	136	17.424K-40-36	51	96
<b>17.424-48-36</b>	60	80	200	20	160	8	M16	18	53	45	137	17.424K-48-36	52	97
<b>17.424-20-48</b>	76	32	140	16 (18)	100	4	M16	18	69	81 (83)	173 (175)	17.424K-20-48	88 (90)	133 (135)
<b>17.424-24-48</b>	76	40	150	16 (18)	110	4	M16	18	69	70 (72)	162 (164)	17.424K-24-48	77 (79)	122 (124)
<b>17.424-32-48</b>	76	50	165	18	125	4	M16	18	69	66	158	17.424K-32-48	63	108
<b>17.424-40-48</b>	76	65	185	18	145	4 (8)	M16	18	69	53	145	17.424K-40-48	60	105
<b>17.424-48-48</b>	76	80	200	20	160	8	M16	18	69	55	147	17.424K-48-48	62	107
<b>17.424-64-48</b>	76	100	220	20	180	8	M16	18	69	64	156	17.424K-64-48	62	107
<b>17.424-24-56</b>	90	40	150	16 (18)	110	4	M16	18	82	77 (79)	169 (171)	17.424K-24-56	84 (86)	129 (131)
<b>17.424-32-56</b>	90	50	165	18	125	4	M16	18	82	56	148	17.424K-32-56	63	108
<b>17.424-40-56</b>	90	65	185	18	145	4 (8)	M16	18	82	56	148	17.424K-40-56	63	108
<b>17.424-48-56</b>	90	80	200	20	160	8	M16	18	82	55	147	17.424K-48-56	62	107
<b>17.424-64-56</b>	90	100	220	20	180	8	M16	18	82	57	149	17.424K-	64	109

												64-56		
<b>17.424-32-64</b>	102	50	165	18	125	4	M16	18	94	134	226	17.424K-32-64	87	135
<b>17.424-40-64</b>	102	65	185	18	145	4 (8)	M16	18	94	66	158	17.424K-40-64	70	118
<b>17.424-48-64</b>	102	80	200	20	160	8	M16	18	94	45	137	17.424K-48-64	49	97
<b>17.424-64-64</b>	102	100	220	20	180	8	M16	18	94	67	159	17.424K-64-64	71	119
<b>17.424-80-64</b>	102	125	250	22	210	8	M16	18	94	67	159	17.424K-80-64	71	119
<b>17.424-64-96</b>	152	100	220	20	180	8	M16	18	142	182	310	17.424K-64-96	109	189
<b>17.424-80-96</b>	152	125	250	22	210	8	M16	18	142	54	182	17.424K-80-96	62	142
<b>17.424-96-96</b>	152	150	285	22	240	8	M20	22	142	54	182	17.424K-96-96	62	142
<b>17.424-128-96</b>	152	200	340	24	295	12	M20	22	142	56	184	17.424K-128-96	64	144

**Note**  
deviating measurements when En flanges are used